

SPECIFICATION:

■ Fluid set	□ 0.8MM. □ 1.0MM
■ Pressure required	3-3.5BAR
■ Air consumption	78.5Liter/min
■ Material output	80-100L/min
■ Air connection	1/4" NPT
■ Approx. Wt	0.44KG
■ Cup	200CC

CONTAINS:

HVLP Spray gun	1set
0.20 Aluminium cup (plastic cup).....	1pc

FEATURES:

- ▲ Fast working speed and wide fan pattern.
- ▲ High transfer efficiency means reduced spray mist.
- ▲ Stainless steel needle and fluid tip allow to use with water borne materials.
- ▲ spray gun 0.20 litres non-drip aluminium cup (plastic cup).

HIGH VOLUME LOW PRESSURE

▲ Significant reduction in operating costs.

Operation:

1.Starting

Prior to any operation, especially after repair work, the seating of screws must be checked and tightened as required. Prior to any repair work the unit must always be disconnected from air pressure circuit.

a) Tighten nozzle set. Air nozzle must be aligned so that the stamped number is visible straight from back to front.

b) Air connection R1/4" Prior to fitting, air hose should be blown out.

c) Prior to shipment this gun was treated with an anticorrosive agent. Before using gun make sure that it is carefully flushed with thinner.

2.Adjustment of the jet width

To adjust jet width, rotate the stepless adjuster. The spray pattern can be altered from flat to round spray as required.

3.Air quantity control

To set the air to material ratio adjust the stepless micrometer. While gun is in operation, never dismantle hollow screw for removal of micrometer by hexagon socket screw key.

4.Exchange of nozzle set

When changing to another nozzle size, make sure that the complete nozzle set is exchanged. A set comprises air cap, paint nee-

PARTSLIST

ITEM No.	Description	ITEM No.	Description
1/HT	AI-Nozzle/HVLP	20	Screw
2	RING	21	Pin
3/HT	AIR Cap/HVLP	22	Air Connection Piece 1/4" NPT/HVLP
4/HT	Fluid Nozzle/HVLP	23	Plastic cup (Aluminium cup)
5	Pacing screw for paint needle	23A	Adaptor
6	Teflon Seal	24	Cover of 0.20 Plastic cup (Aluminium cup)
7	Washer	24B	Non-drip Control Device
8	Spring	25A+B	Air Piston
9	Brass Ring (TO open clockwise)	25F	Teflon Seal
10	Gasket	25G	Nut
11	Connector for 0.20 Cup	25H	Screw
12	Gun Body		
13	Screw		
13C	Teflon seal		
13D	Body		
13E	P.C.seal		
13F	Valve		
13G	Valve		
13H	Spring		
14	Washer		
14A	Spray Regulating Screw		
14B	Spray Regulating Nut		
14C	C-Ring		
15	Control knob		
15A	Countersunk Screw		
16	Paint needle-Complete/HVLP		
17	Spring for Paint needle		
18	Lockout for Fluid Control knob		
18A	Fluid Control knob		
19	Trigger		

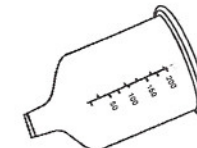
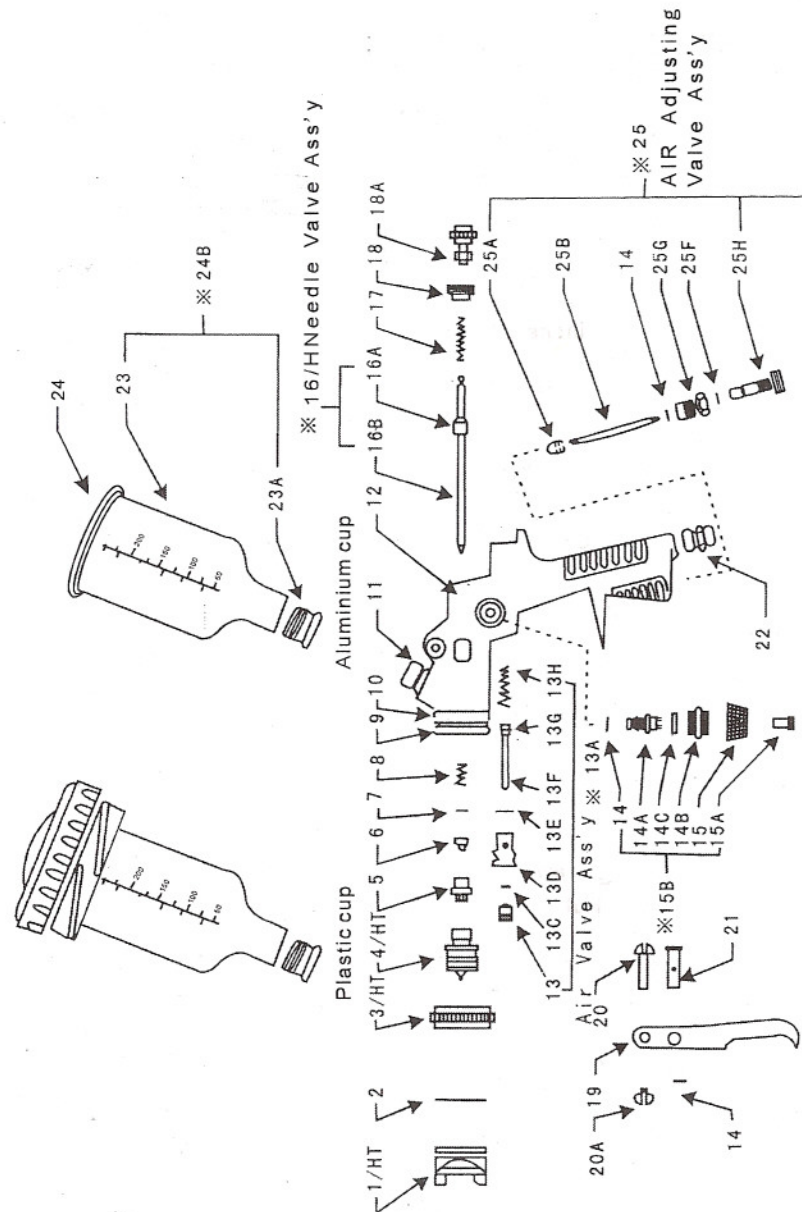

Spare Cup (Complete set)

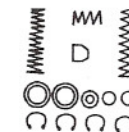

Repair Kit for spray gun
PARTS NO: 06 07 08 13C 13E
13H 14C 14X4PC 33F 17

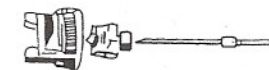

Nozzle set 0.8mm 1.0mm